

TIMKEN**The Timken Company**

4500 Mt Pleasant St. NW

N. Canton, OH 44720

Phone: (234) 262-3000**E-Mail:** CustomerCAD@timken.com • **Web site:** www.timken.com**Part Number 7309 BTN1, Timken® Single Row Angular Contact Ball Bearings (7200, 7300)**

Timken® angular contact ball bearings are designed for combination radial and axial loading. Single-row bearings have high thrust capacity in one direction. Some single-row bearings are specifically designed for duplex mounting in sets for maximum performance.

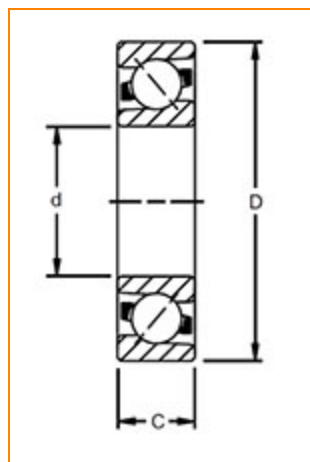

[Dimensions](#) | [Basic Load Ratings](#) | [Factors](#) | [Specifications](#) | [Abutment and Fillet Dimensions](#)

Dimensions

d - Bore	45.00 mm 1.7717 in
D - Outer Diameter	100.00 mm 3.9370 in
Bearing Width	25.00 mm 0.9843 in
Contact Angle	40 °

Basic Load Ratings

C0 - Static Radial Rating	36800 N 8271 lbf
----------------------------------	---------------------



55000 N

C1 ISO - Dynamic Radial Rating	55000 N 12362 lbf
--------------------------------	----------------------

Factors

Limiting Speed (Grease)	6600 rpm
-------------------------	----------

Limiting Speed (Oil)	8900 rpm
----------------------	----------

Specifications

Ball Type	STEEL
-----------	-------

Cage Type	Molded
-----------	--------

Cage Material	Polyamide
---------------	-----------

Bearing Weight	0.85 Kg 1.874 lb
----------------	---------------------

Design Units	METRIC
--------------	--------

R - Inner Ring "Touch" Radius	0.6
-------------------------------	-----

r - Outer Ring "Touch" Radius	0.6
-------------------------------	-----

Features	Open
----------	------

Abutment and Fillet Dimensions

R - Inner Ring "To Clear" Radius ¹	1.00 mm 0.039 in
---	---------------------

r - Outer Ring "To Clear" Radius ²	1.00 mm 0.039 in
---	---------------------

da - Inner Ring Backing Diameter	53.5 mm 2.106 in
----------------------------------	---------------------

Da - Outer Ring Backing Diameter	91.5 mm 3.602 in
----------------------------------	---------------------

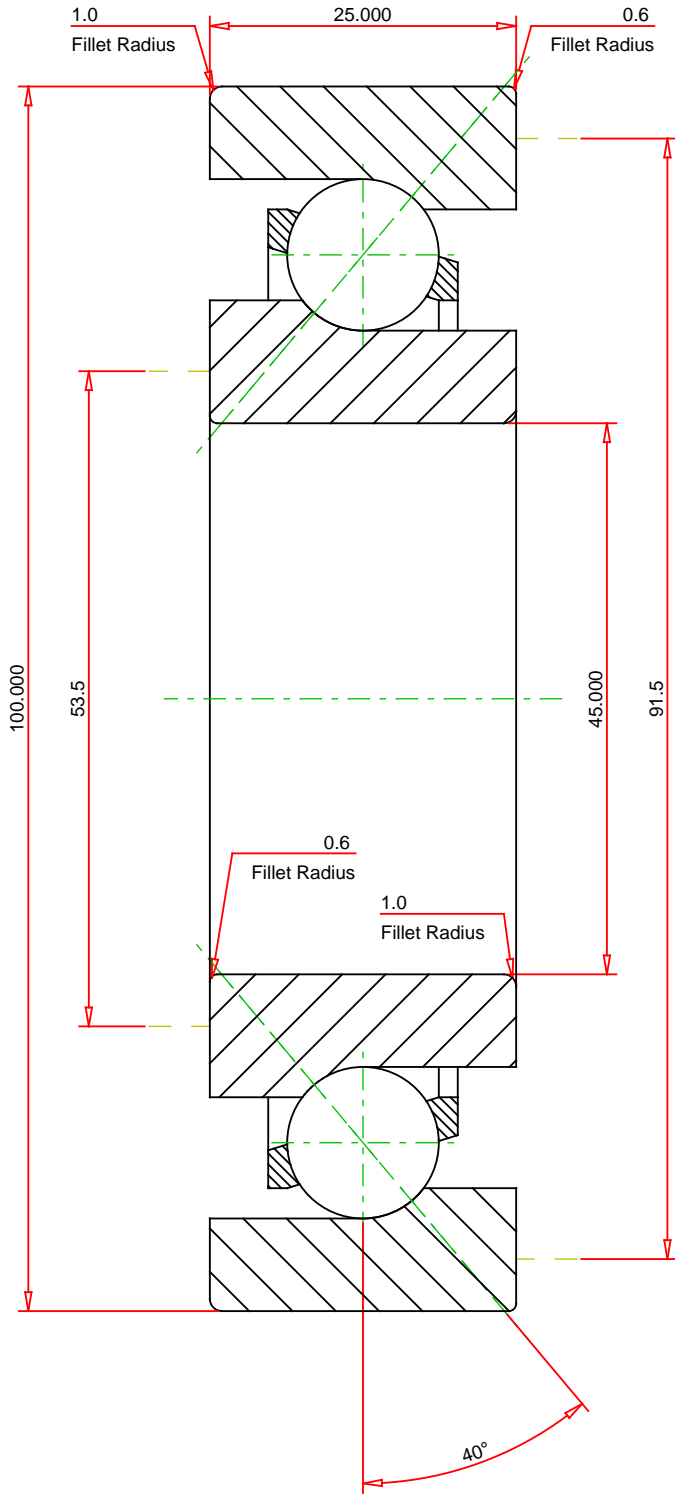

METRIC UNITS

Number of Balls Per Row 11
 Bearing Weight 0.850 kg

TIMKEN®

7309 BTN1
 Timken® Single Row Angular Contact Ball Bearings
 (7200, 7300)

THE TIMKEN COMPANY
 NORTH CANTON, OHIO USA

Dynamic Radial Rating 55000 N
 Static Radial Rating 36800 N

Every reasonable effort has been made to ensure the accuracy of the information contained in this writing, but no liability is accepted for errors, omissions or for any other reason.

FOR DISCUSSION ONLY